

## QuickStart Setup Guide

## Add-on Kit Components

## System Requirements



### Logitech® Spy Camera Add-On™

**Congratulations** on purchasing an Add-on Spy Camera! With this kit, you have the components to mount your new camera wherever you need it.

This Quickstart Setup Guide will assist you in placing and setting up your additional camera to your video surveillance system. Simply follow the instructions and you will be viewing live video from your new camera in minutes.



- 1) Spy Camera
- 2) Power Cord

**Warning:** Due to the discreet nature of this camera, its use may be subject to national, state, and local laws respecting copyright, right of publicity, and privacy. Before using this camera you should become familiar with the pertinent laws, regulations, and community standards that may bear on the use, publication, or distribution of recordings to ensure compliance with applicable laws.

Below, you can find the minimum and recommended requirements for systems running cameras using the default QVGA (320x240) settings. Running your cameras in the higher VGA (640x480) mode may require additional resources.

The WiLife Video Security System uses your Windows PC to record the video from your cameras and serve video to your remote devices. You need to have your PC on and running for the Wilife system to operate.

Requirements	Number of Cameras					
	1	2	3	4	5	6
<b>CPU Speed:</b> Recommended	2.2 GHz	2.4 GHz	2.6 GHz	2.8 GHz	3.0 GHz	3.2 GHz
<b>Memory (MB):</b> Recommended	512	512	512	768	1024	1024
<b>Video Card (MB):</b> Recommended DirectX 9 compatible	32	32	64	128	128	256
<b>Display Resolution:</b>	1024 x 768 or higher, 32 bit color					
<b>Hard Drive (MB):</b>	100 MB for program and a minimum of 500+ MB for video storage.					
<b>Operating System:</b>	Microsoft® Windows® Vista™ or Microsoft® Windows® XP Home Edition XP Professional or XP Media Center Edition					
<b>Media Player:</b>	Microsoft Windows Media® Player 9 or later					

\* Intel® Pentium 4 CPU speed. Dual-core Intel and AMD processors deliver similar performance at lower clock speeds.  
\*\*Microsoft Vista requires more memory to deliver equal performance.



Modern design and styling ensure that the spy camera looks natural, wherever you choose to position it.

### Step 1 Run WiLife Software

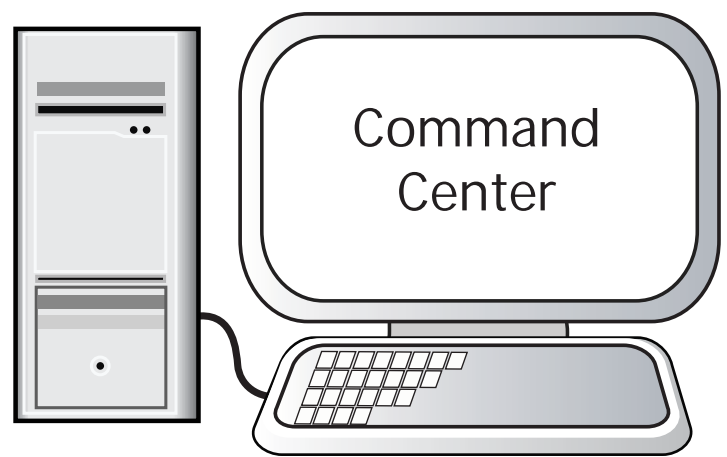

**Please read all instructions before starting the installation.**

- Have the WiLife Command Center running on your PC.

**Caution:**

- To ensure a quality connection, do NOT plug these devices or into a surge protector or powerstrip. They already have a built-in surge protection and must be plugged directly into your wall outlet.

**Notes:**

- If you set a custom password in the WiLife Command Center, you will need to complete these tasks:
  - 1) In Command Center, click Setup and go to the Advanced tab screen.
  - 2) Click the Find My Cameras button. It will take WiLife 1 to 2 minutes to locate the camera.

### Step 2 Plug in the Spy Camera

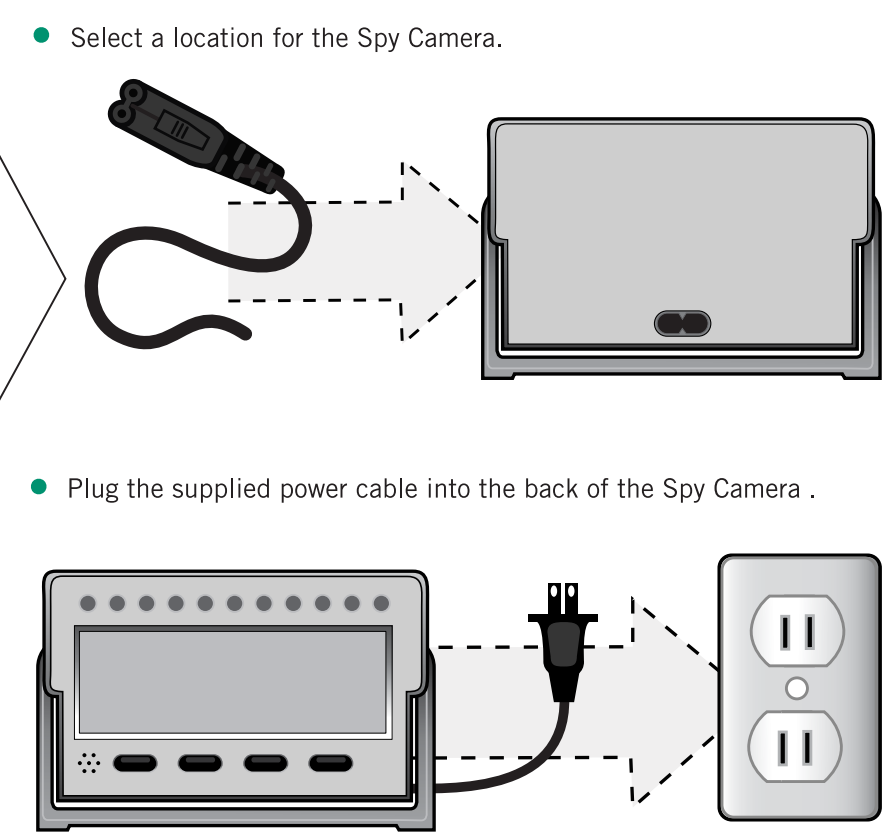

- Select a location for the Spy Camera.
- Plug the supplied power cable into the back of the Spy Camera .
- Plug the clock into your wall outlet.
- Wait for the software to finish.
- When installation is complete, restart your PC.

**Setting the Time:**

- **+/-** Hold down the button at the same time as the 12:-- or --:00 to change hours or minutes.
- **12/24** Press and release button to toggle between 12-hour standard time or 24-hour military time
- **12:--** Holding down the +/- button, press 12:-- until the desired hour shows.
- **--:00** Holding down the +/- button, press --:00 until the desired minute shows.

### Step 3 Adjust the Spy Camera

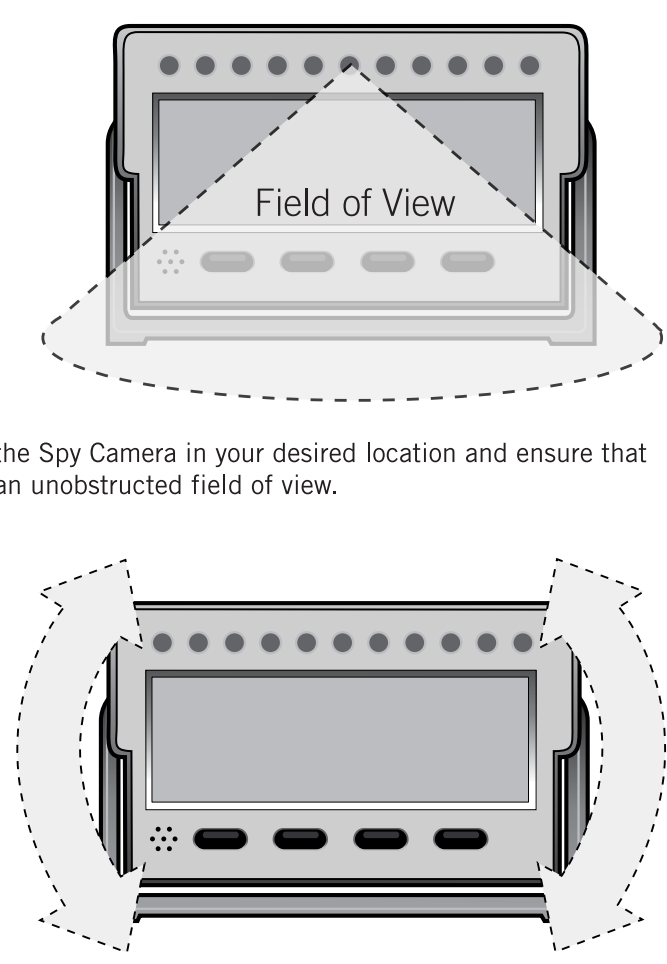

- Place the Spy Camera in your desired location and ensure that it has an unobstructed field of view.
- Adjust the field of view by tilting the camera up or down to ensure complete coverage of the area you wish to monitor.

### Build a Complete Surveillance System

The WiLife Video Security System is available online at [www.wilife.com](http://www.wilife.com) and at other select retail stores and authorized resellers. Visit [www.wilife.com](http://www.wilife.com) to find a store or reseller near you.



Add-on Indoor Camera



Add-on Outdoor Camera



Add-on Spy Camera

